

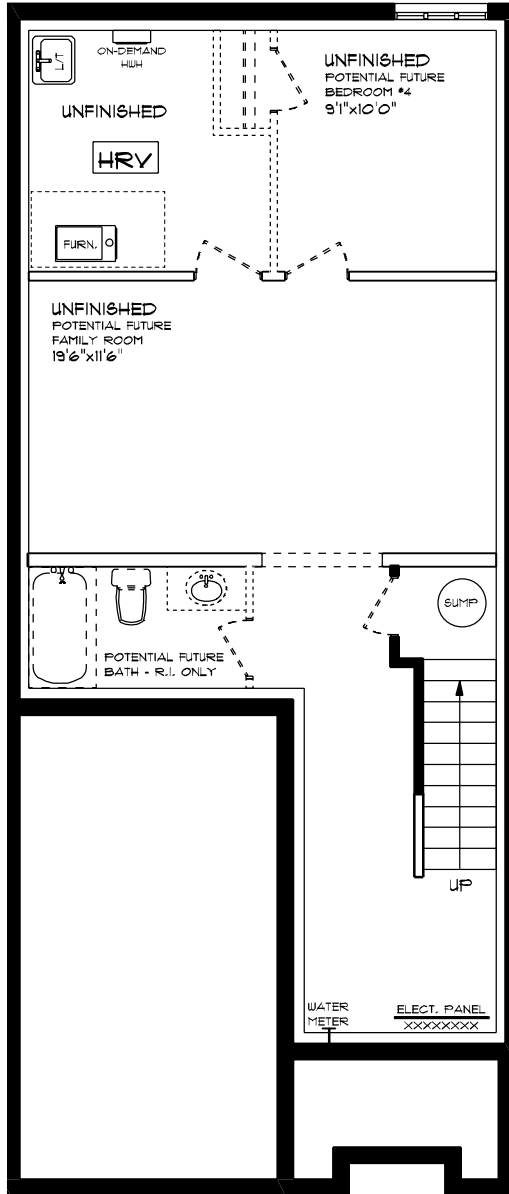

**SHELTON (ESSENTIAL SPECS)
LOT 49D (#9) HEMLOCK CRESCENT
FRONT ELEVATION
9' MAIN FLOOR CEILING
APPROX. 1,622 SQ. FT.**

This plan is the property of Highline Homes and any reproduction of this plan, its concepts or ideas, is strictly prohibited. Plans and specifications are approximate and are subject to change without notice. Finished area and room dimensions will change depending on front elevation selection. E.A.O.E. 2024

CREATED MAR. 2024



SHELTON (ESSENTIAL SPECS)
 LOT 49D (#9) HEMLOCK CRESCENT
 LOWER LEVEL PLAN

UNFINISHED

This plan is the property of Highrise Homes and any reproduction of this plan, its concepts or ideas, is strictly prohibited. Plans and specifications are approximate and are subject to change without notice. Finished area and room dimensions will change depending on front elevation selection. E.A.O.E. 2014

CREATED MAR. 2014

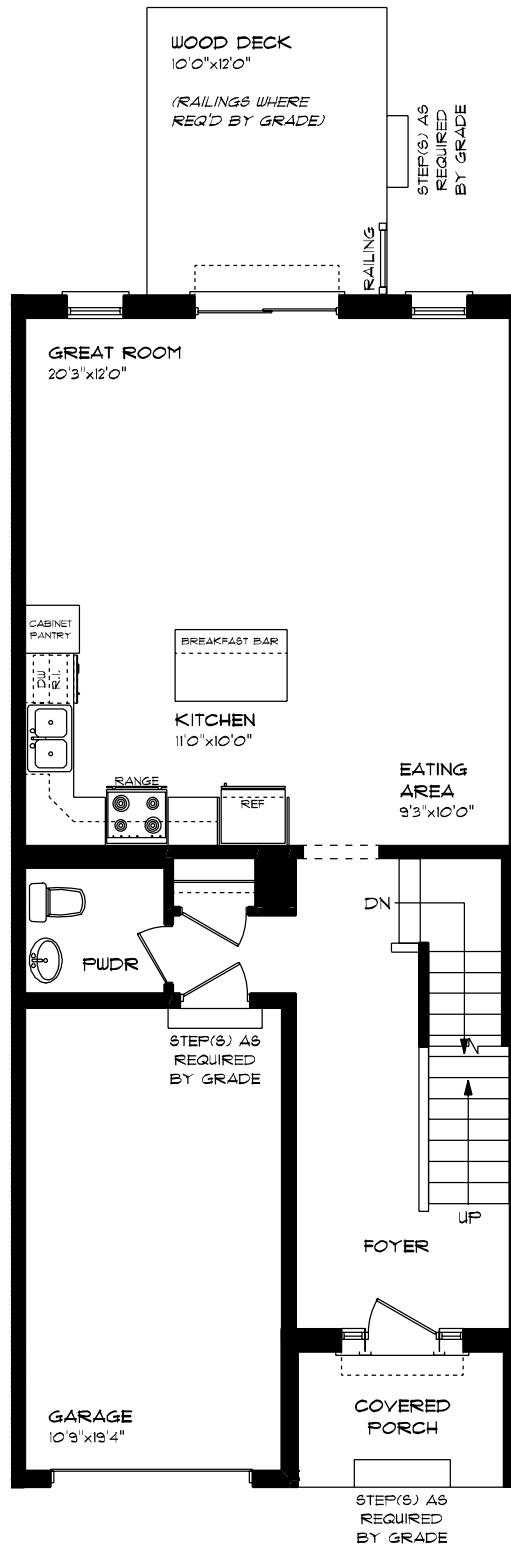

SHELTON (ESSENTIAL SPECS)
LOT 49D (#9) HEMLOCK CRESCENT
MAIN FLOOR PLAN
9' MAIN FLOOR CEILING
APPROX. 165 SQ. FT.

This plan is the property of Hagfish Homes and any reproduction of this plan, its concepts or ideas, is strictly prohibited. Plans and specifications are approximate and are subject to change without notice. Finished area and room dimensions will change depending on front elevation selection. E.A.O.E. 2024

CREATED MAR. 2024

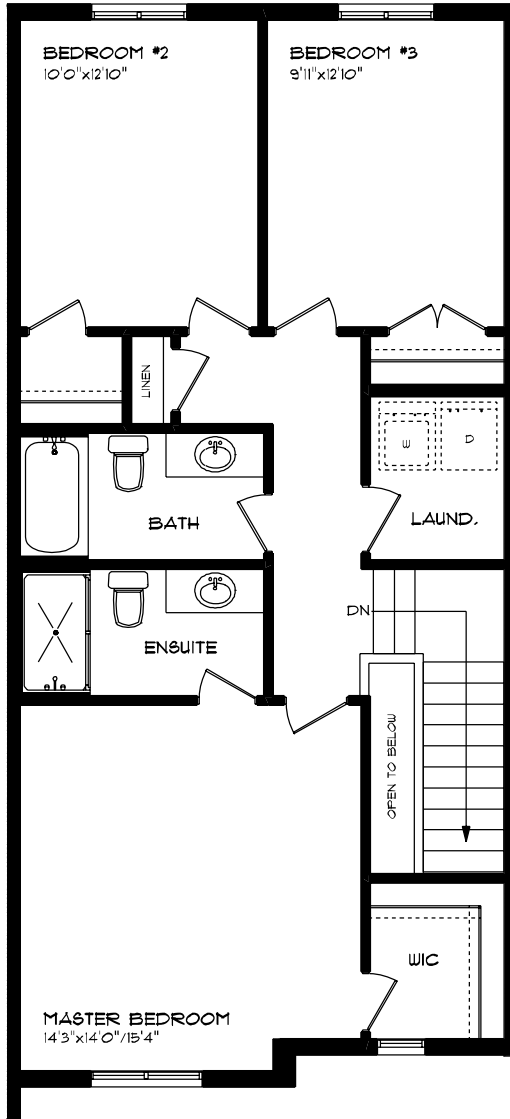

**SHELTON (ESSENTIAL SPECS)
 LOT 49D (#9) HEMLOCK CRESCENT
 SECOND FLOOR PLAN**

APPROX. 851 SQ. FT.

This plan is the property of Mayhew Homes and any reproduction of this plan, its concepts or ideas, is strictly prohibited. Plans and specifications are approximate and are subject to change without notice. Finished areas and room dimensions will change depending on front elevation selection. E.A.O.E. 2024

CREATED MAR. 2024